

Ring Type Lugs

RING NON-INSULATED

RECOMMENDED TOOLS

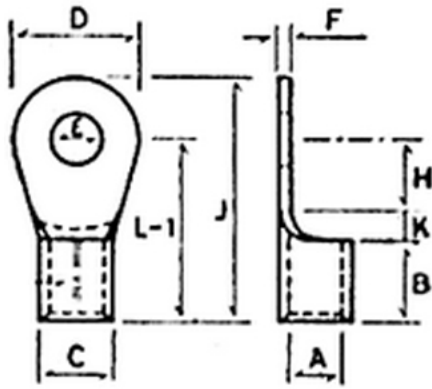

mm ²	E BOLT MM	ØA	D	B	G	L-1	dowell's cat no	RECOMM. TOOLS RS.	ØC	L-1	dowell's cat no	RECOMM. TOOLS RS.	ØA-1	L-1	dowell's cat no	TOOLS
1.5	M3	1.6	6	5	3	11	RS-7001	SYT-2	3.2	16	RSI-7064	SYT-1225	3.6	16	PSD-7437	SYT-1225
	M3.5	1.6	6.8	5	3.4	9.6	RS-7002		3.2	14.6	RSI-7066		3.6	14.6	PSD-7438	
	M4	1.6	8	5	4	12	RS-7003		3.2	17	RSI-7068		3.6	17	PSD-7439	
	M4	1.6	8	5	4	12	RS-7048		3.2	18	RSI-7069		3.6	18	PSD-7441	
	M5	1.6	10	5	3.5	11	RS-7049		3.2	18	RSI-7070		3.6	18	PSD-7442	
	M4	1.6	7	5	5	13	RS-7004		3.2	17	RSI-7071		3.6	17	PSD-7444	
	M5	1.6	10	5	5	13	RS-7005		3.2	18	RSI-7072		3.6	18	PSD-7445	
	M6	1.6	12	5	6	12	RS-7154		3.2	17	RSI-7082		3.6	17	PSD-7448	
2.5	M3	2.3	6.5	5	3.2	9.5	RS-7107	SYA-427	3.9	14.5	RSI-7088	SYT-1225	4.4	17.7	PSD-7451	SYT-1225
	M3.5	2.3	8	5	4	12	RS-7008		3.9	17	RSI-7089		4.4	17	PSD-7452	
	M3.5	2.3	8	5	4	12	RS-7108		3.9	18	RSI-7070		4.4	18	PSD-7453	
	M4	2.3	10	5	5	13	RS-7009		3.9	21	RSI-7071		4.4	21	PSD-7454	
	M5	2.3	12	5	6	16	RS-7010		3.9	22	RSI-7072		4.4	22	PSD-7455	
	M5	2.3	12	5	6	16	RS-7109		3.9	25	RSI-7073		4.4	25	PSD-7456	
	M8	2.3	16	5	8	17	RS-7011		3.9	22	RSI-7074		4.4	22	PSD-7457	
	M5	2.3	12	5	6	16	RS-7110		3.9	25	RSI-7075		4.4	25	PSD-7458	
	M8	2.3	16	5	8	17	RS-7012		3.9	22	RSI-7076		4.4	22	PSD-7459	
	M8	2.3	16	5	8	17	RS-7013		3.9	25	RSI-7077		4.4	25	PSD-7460	
4-6	M4	3.5	8	6	4	13	RS-7155	SYT-17	5.5	21	RSI-7083	SYT-1246	6.4	22	PSD-7466	SYT-1246
	M5	3.5	10	6	5	14	RS-7050		5.5	22	RSI-7084		6.4	23	PSD-7467	
	M6	3.5	12	6	6	14	RS-7014		5.5	26.5	RSI-7088		6.4	27.5	PSD-7469	
	M8	3.5	14	6	7	16	RS-7015		5.5	24	RSI-7089		6.4	25	PSD-7472	
	M6	3.5	12	6	6	16	RS-7118		5.5	30	RSI-7090		6.4	31	PSD-7473	
	M6	3.5	14	6	7	16	RS-7019		5.5	29	RSI-7092		6.4	30	PSD-7475	
	M8	3.5	16	6	8	17	RS-7116		5.5	29	RSI-7093		6.4	30	PSD-7476	
	M8	3.5	16	6	8	17	RS-7020		5.5	29	RSI-7094		6.4	30	PSD-7477	
	M10	3.5	18	6	9	19	RS-7111		5.5	29	RSI-7098		6.4	30	PSD-7479	
	M12	3.5	18	6	9	19	RS-7024		5.5	29	RSI-7099		6.4	30	PSD-7482	

MM2	E BOLT MMØ	ØA	D	B	G	L-1	Dowell's cat no	RECOMMENDED TOOLS & DIES				STD. PKG.
								SYB-95	SYD-20	SYE-150	SYT-8	
10	M5	4.3	10	8	5	17	RS-7025	SYT-2 SYT-25	JBR-1		10	200
	M5	4.3	12	8	5	15	RS-7026					
	M6	4.3	16	8	6	17	RS-7120					
	M8	4.3	22	8	8	19	RS-7121					
	M10	4.3	22	8	11	23	RS-7123					
	M12	4.3	22	8	11	23	RS-7028					
16	M5	5.6	10	10	5	19	RS-7124	SYT-2 SYT-26	JBR-2		16	200
	M6	5.6	12	10	6	20	RS-7029					
	M8	5.6	16	10	8	22	RS-7030					
	M10	5.6	22	10	11	24	RS-7128					
	M12	5.6	22	10	11	24	RS-7033					
	M8	7.5	12	11	6	25	RS-7156					
25	M8	7.5	16	11	8	22	RS-7034	SYT-27	JBR-5		25	100
	M10	7.5	22	11	11	31	RS-7132					
	M12	7.5	22	11	11	31	RS-7037					
	M8	9	16	12	8	23	RS-7133					
	M8	9	16	12	8	23	RS-7038					
	M10	9	22	12	11	31	RS-7135					
35	M12	9	22	12	11	31	RS-7040	SYT-28	JBR-6		35	100
	M8	10.5	18	16	9	34	RS-7136					
	M10	10.5	22	16	11	32	RS-7137					
	M12	10.5	24	16	12	36	RS-7042					
	M16	10.5	32	16	16	38	RS-7139					
	M10	12	22	18	11	36	RS-7140					
70	M12	12	24	18	12	36	RS-7141	JBR-9			70	50
	M16	12	28	18	14	40	RS-7142					
	M10	13.5	24	20	12	38	RS-7144					
	M12	13.5	24	20	12	38	RS-7044					
	M16	13.5	28	20	14	44	RS-7145					
	M12	15	26	22	13	39	RS-7146					
120	M16	15	32	22	16	48	RS-7147	JBR-11				30
	M20	15	40	22	20	52	RS-7148					
	M12	16.5	34	24	17	49	RS-7149					
	M16	16.5	34	24	17	49	RS-7045					
	M20	16.5	40	24	20	54	RS-7046					
	M12	16.5	34	24	17	49	RS-7045					